



TEGNFORKLARING - TERRENG

	Reguleringsplangrense		Målsetting		Gangsoner		Eksisterende trær bevares (ikke innmålt)		Sykkelparkering
	Reguleringsplangrense SVV		Inngang/innngang		Møbleringssone		Nye trær		Utemøbler
	Eiendomsgrense/gbr.nr.		Frisktsone		Forhage (privat sone)		Store busker/småtrær		Uteservering/kantine
	Formålsgrense		Eksisterende bygninger		Lek/aktivitet		Jernbaneskinner eks.		Lek
	Byggegrense		Planlagte bygninger		Plantefelt		HC parkering		Brannopstillingsplass
	Prosj. koter		Takoverbygg		Regnbed		Mur		Sykkelføfelt
	Punkthøyder (eks.)/prosjektort		Fortau		Plen		Rampe		Omriss garasje
	GH = gesimshøyde MH = mønehøyde		Kjøreareal		Torgflate		Trapp		Vannrenne
	Eks. koter		Gjerde		Nedgravd bunntomt container for glass og metall		Støyskjerm		

TEGNFORKLARING - TAK

	Takhager
	Grønne tak med fordrøyning/solenergianlegg
	Grønne tak med fordrøyning

PROSJEKTFASE:
REGULERINGSFASE

OBOS Nye Hjem AS
ÅRSTAD, GNR 159 BNR 81 MFL., DELFELT S19 OG S20, MINDEMYREN

Plan ID 4601_71140000
Illustrasjonsplan tak/terreng

BASISKART
KORDINATSYSTEM: UTM32N
HØYDESYSTEM: NN00
ELEVATION: 1m

SAK NR.: 3002

TEGN NR.: L30-01

MÅLSTOKK: 1:500 (A1)

TEGNET AV: JVV/SH
KONTR.: VJM
DATO: 15.01.26

Prinsippsnitt A-A'

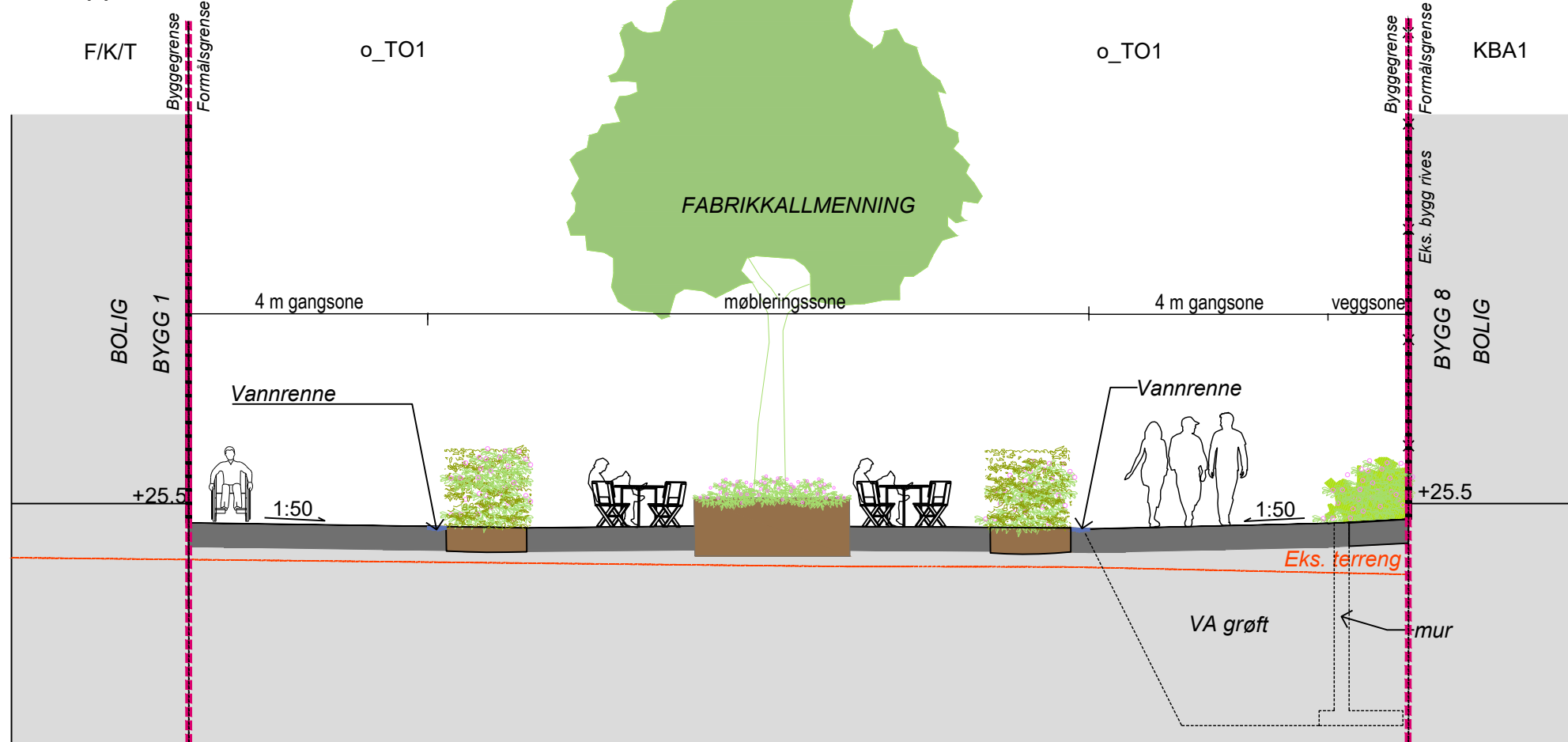

Prinsippsnitt B-B'

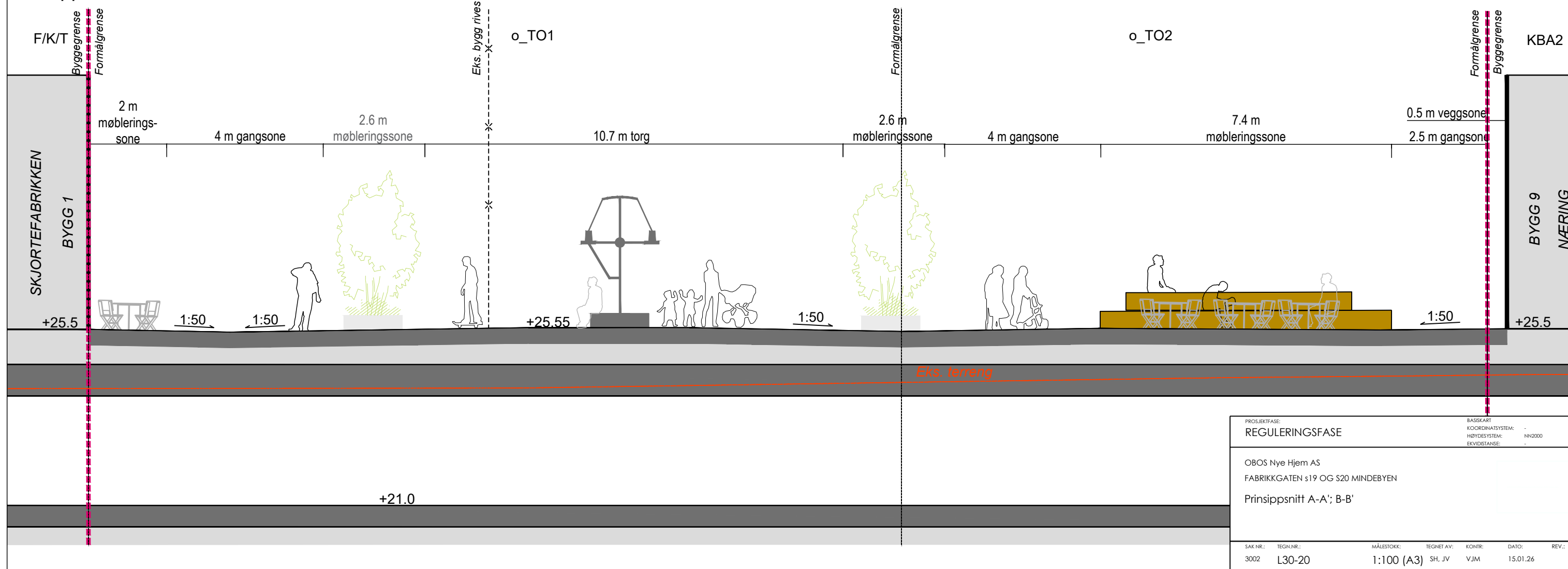

PROSJEKTFASE: REGULERINGSFASE		BASISKART KORDINATSYSTEM: - HØYDESISTEM: NN2000 EKVIDISTANSE: -	
OBOS Nye Hjem AS FABRIKKGATEN s19 OG S20 MINDEBYEN Prinsippsnitt A-A'; B-B'			
SAK NR.: 3002	TEGN.NR.: L30-20	MÅLSTOKK: 1:100 (A3)	TEGNET AV: SH, JV
KONTR.: VJM		DATE: 15.01.26	REV.:

Prinsippsnitt C-C'

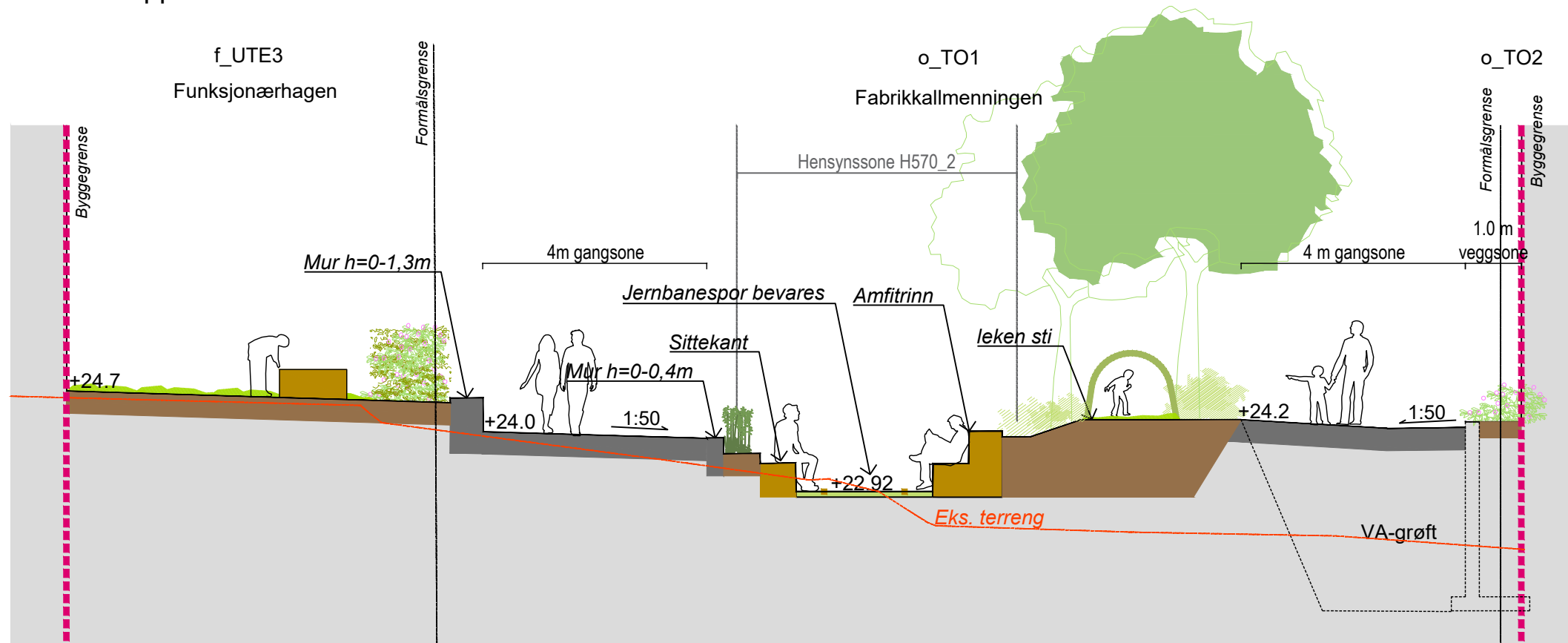

Prinsippsnitt D-D'

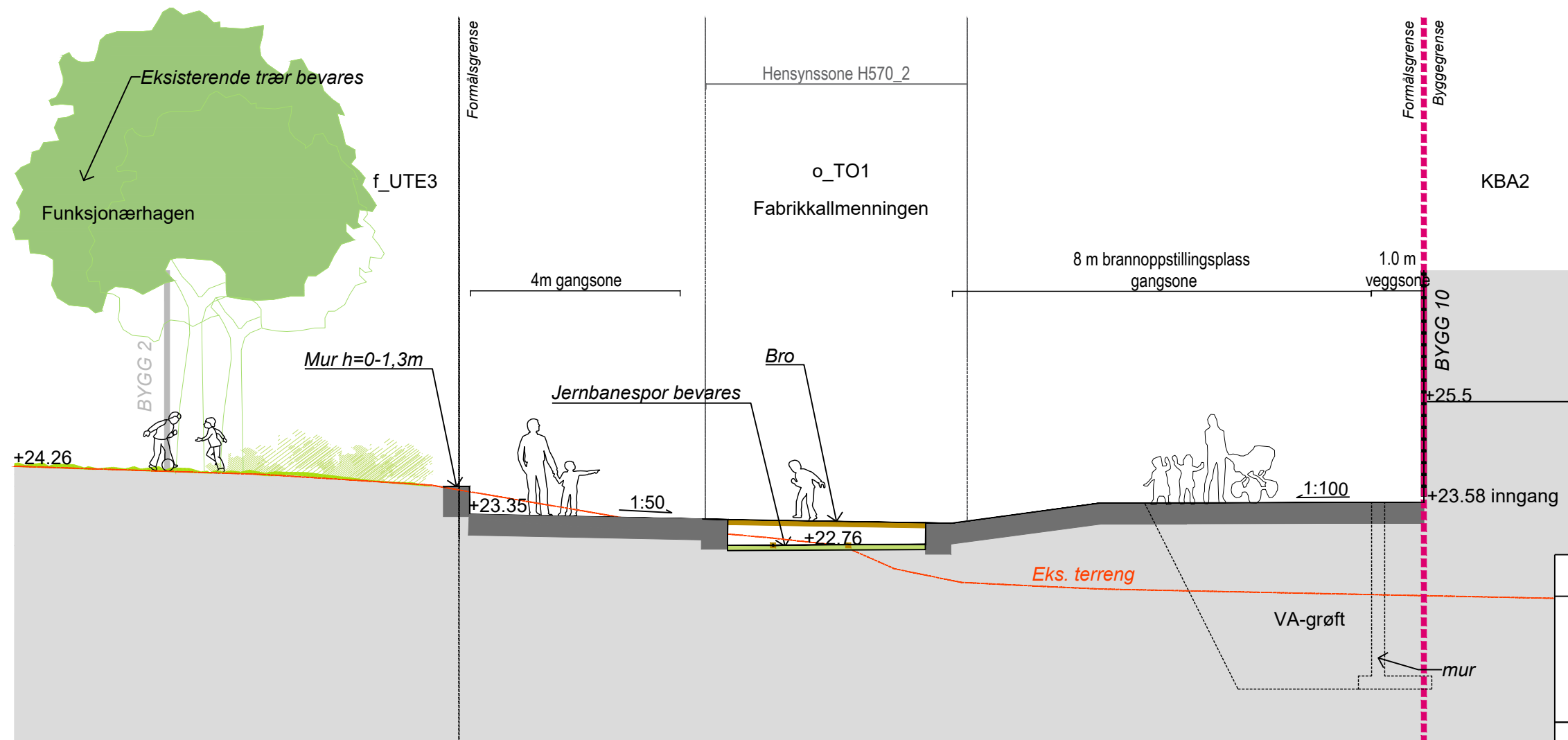

PROSJEKTFASE: REGULERINGSFASE		BASISKART KORDINATSYSTEM: - HØYDESISTEM: NN2000 EKVIDISTANSE: -	
OBOS Nye Hjem AS FABRIKKGATEN s19 OG S20 MINDEBYEN Prinsippsnitt C-C'; D-D'			
SAK NR.: 3002	TEGN.NR.: L30-21	MÅLESTOKK: 1:100 (A3)	TEGNET AV: JV
KONTR.: vjm		DATE: 15.01.26	REV.:

Prinsippsnitt E-E'

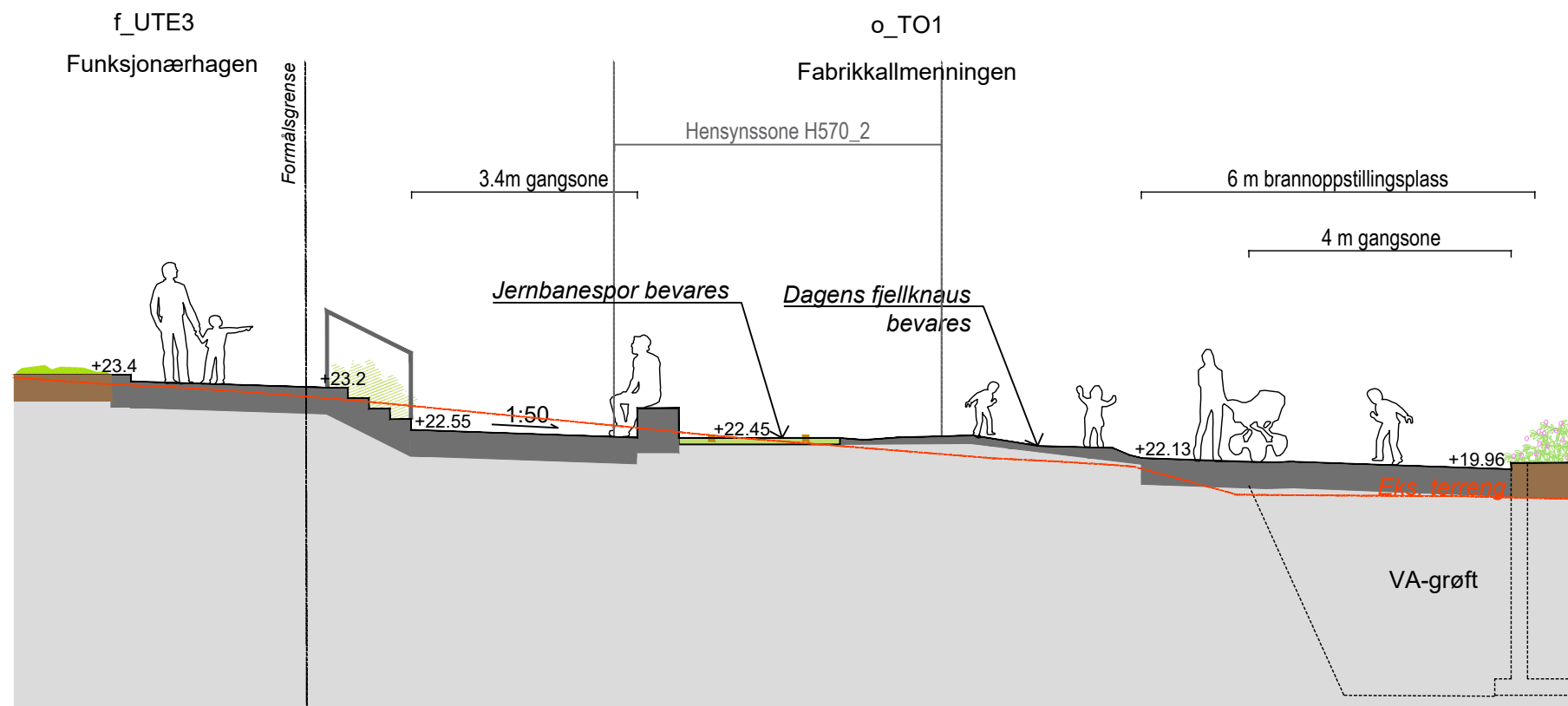

Prinsippsnitt F-F'

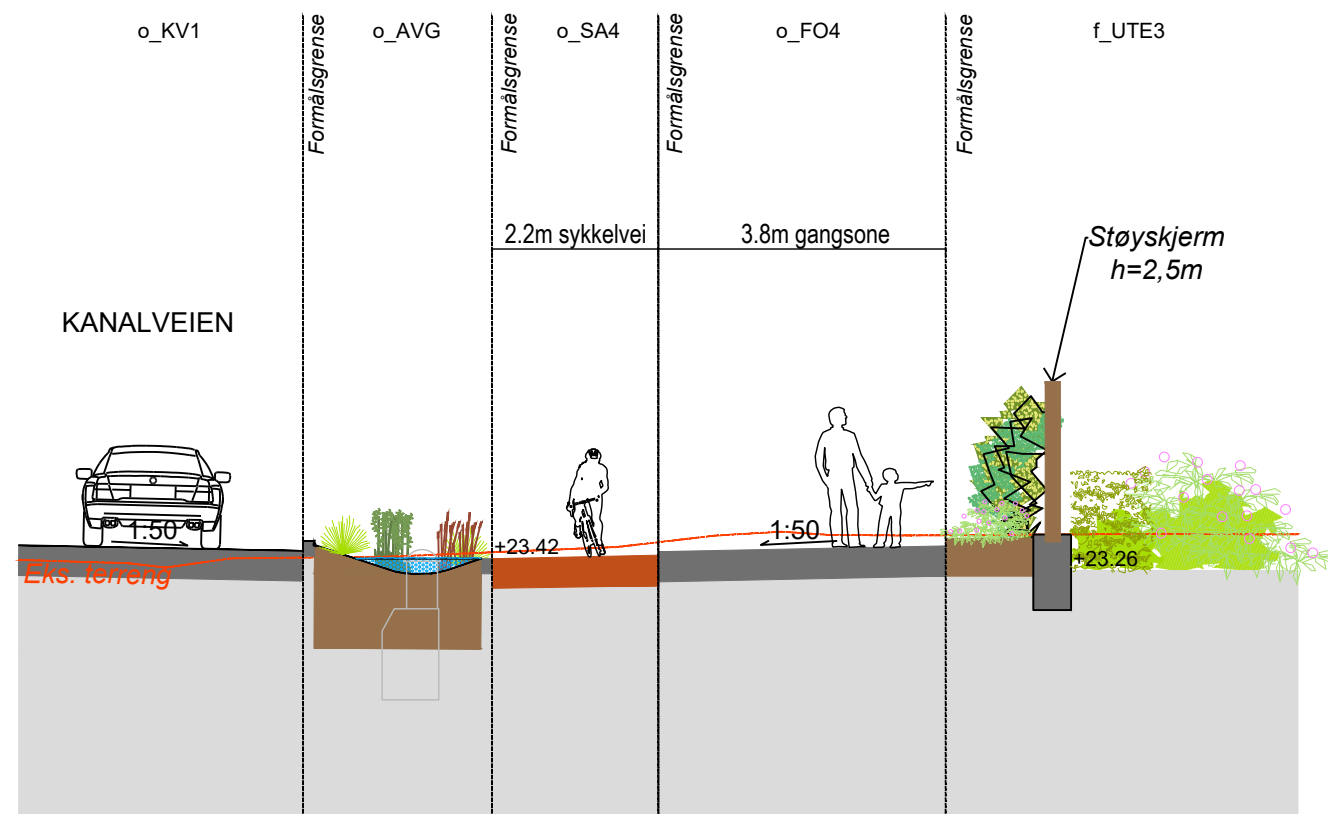

PROSJEKTFASE: REGULERINGSFASE		BASISKART KORDINATSYSTEM: - HØYDESISTEM: NN2000 EKVIDISTANSE: -	
OBOS Nye Hjem AS FABRIKKGATEN s19 OG S20 MINDEBYEN Prinsippsnitt E-E'; F-F'			
SAK NR.:	TEGN.NR.:	MÅLSTOKK:	TEGNET AV: KONR: DATO: REV.:
3002	L30-22	1:100 (A3)	JV vjm 15.01.26

Lengdesnitt G-G' - Fabrikallmenning 1:450

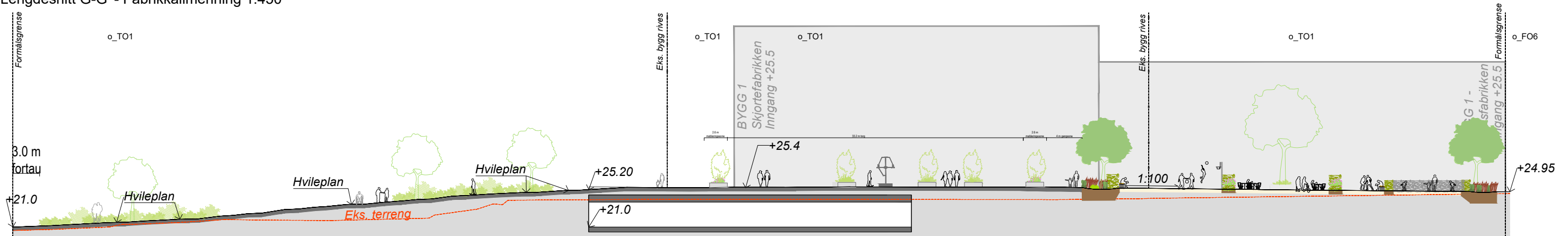

Lengdesnitt H-H' - Boliggaten 1:300

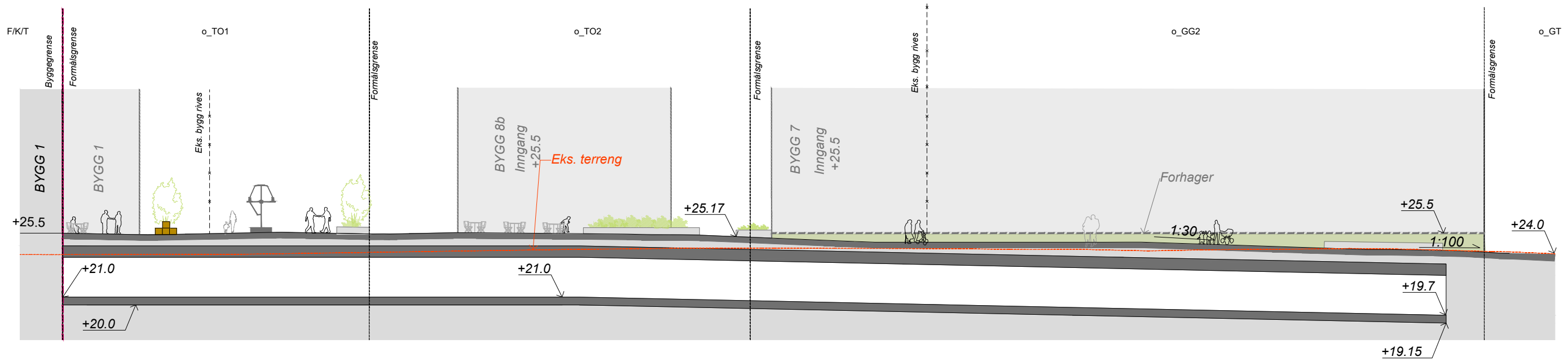

PROSJEKTFASE: REGULERINGSFASE		BASISKART KООORDINATSYSTEM: - HØYDESISTEM: NN2000 EKVIDISTANSE: -	
OBOS Nye Hjem AS FABRIKKGATEN s19 OG S20 MINDEBYEN Snitt G-G', H-H'			
SAK NR.: 3002	TEGN.NR.: L30-23	MÅLESTOKK: 1:300/450	TEGNET AV: SH,JV KONIR: VJM DATO: 15.01.26 REV.: -

Lengdesnitt I-I' - Torg og Mindehagen 1:300

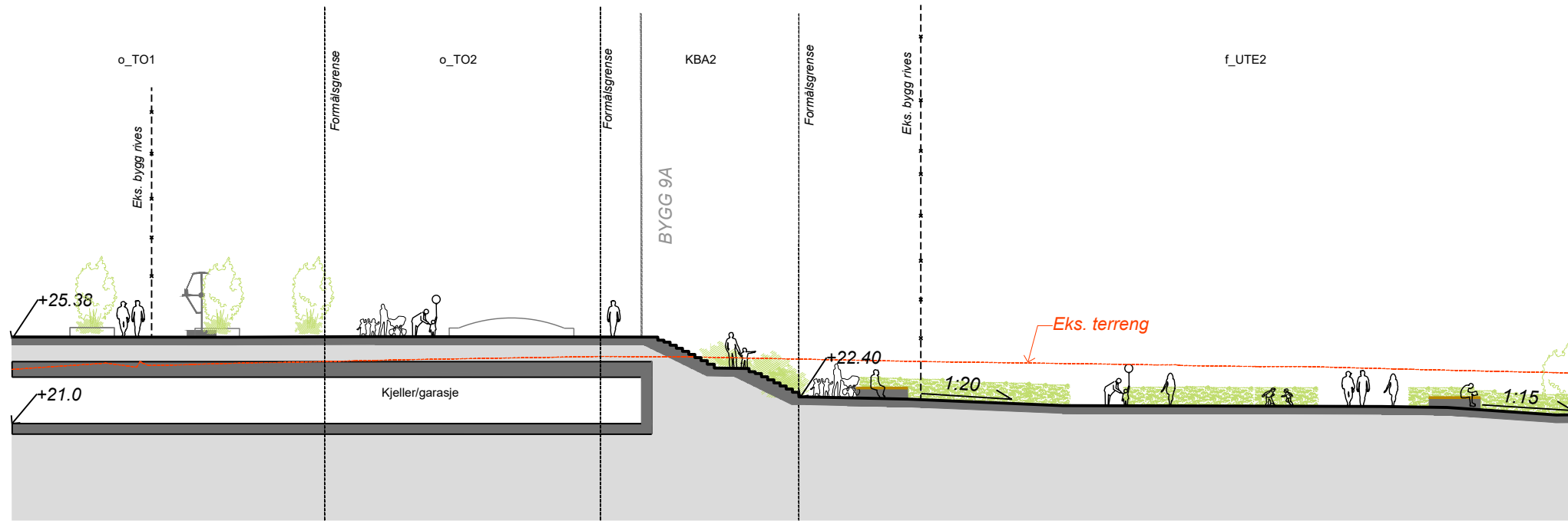

Lengdesnitt J-J' 1:250

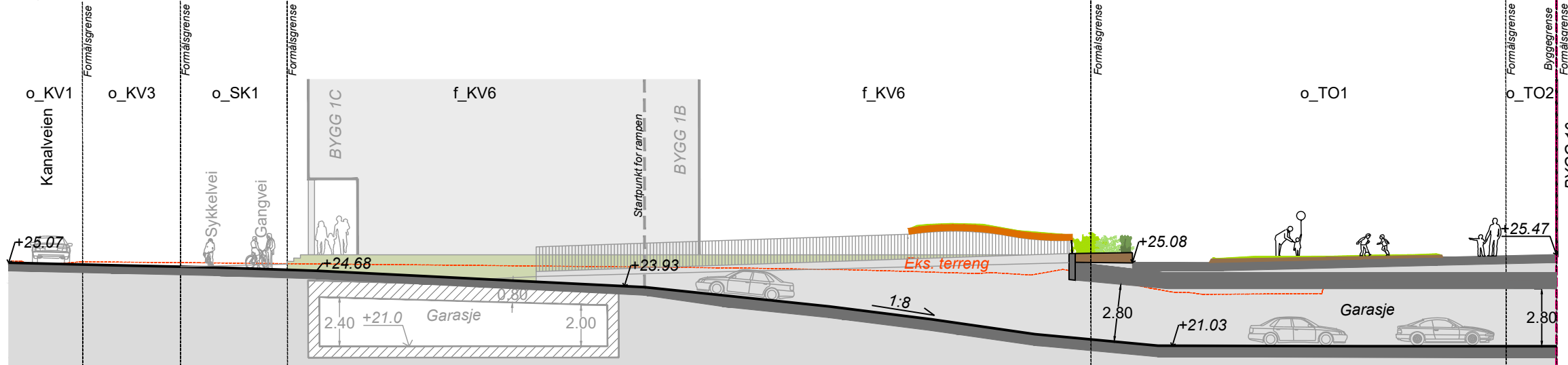

Prinsippsnitt K-K' 1:100

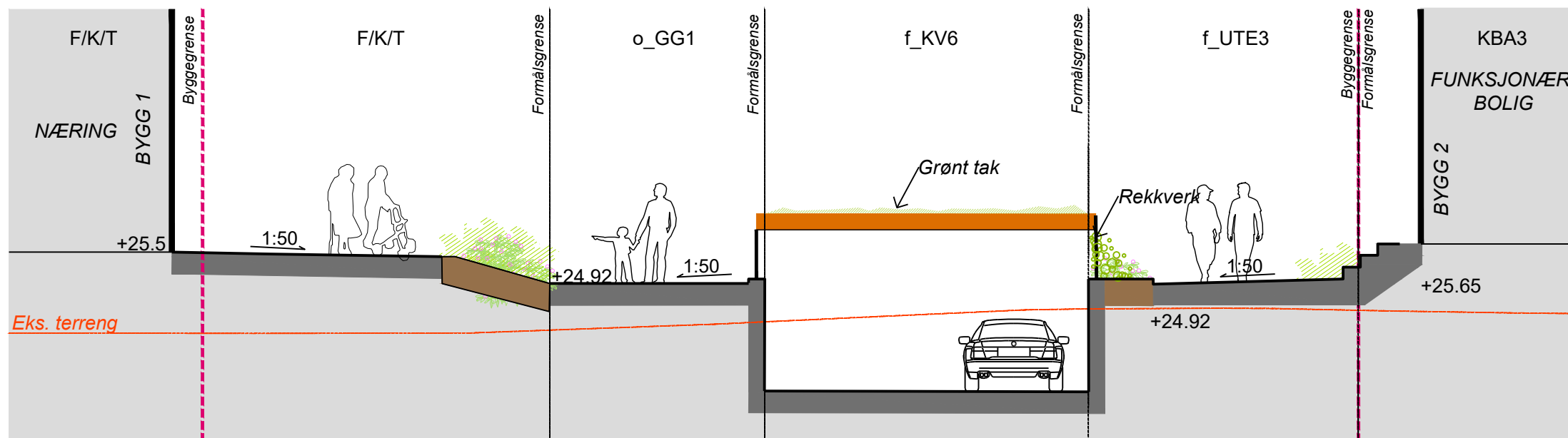

PROSJEKTFASE: REGULERINGSFASE		BASISKART	-
		KOORDINATSYSTEM:	NN2000
		HØYDESISTEM:	-
		EKVIVESTANSE:	-
OBOS Nye Hjem AS FABRIKKGATEN s19 OG S20 MINDEBYEN Prinsippsnitt I-I'; J-J', K-K''			
SAK NR.:	TEGN. NR.:	MÅLESTOKK:	TEGNET AV:
3002	L30-24	VAR. (A3)	JV
		KONR.:	DATE:
		VJM	15.01.26
		REV.:	

Prinsippsnitt L-L'

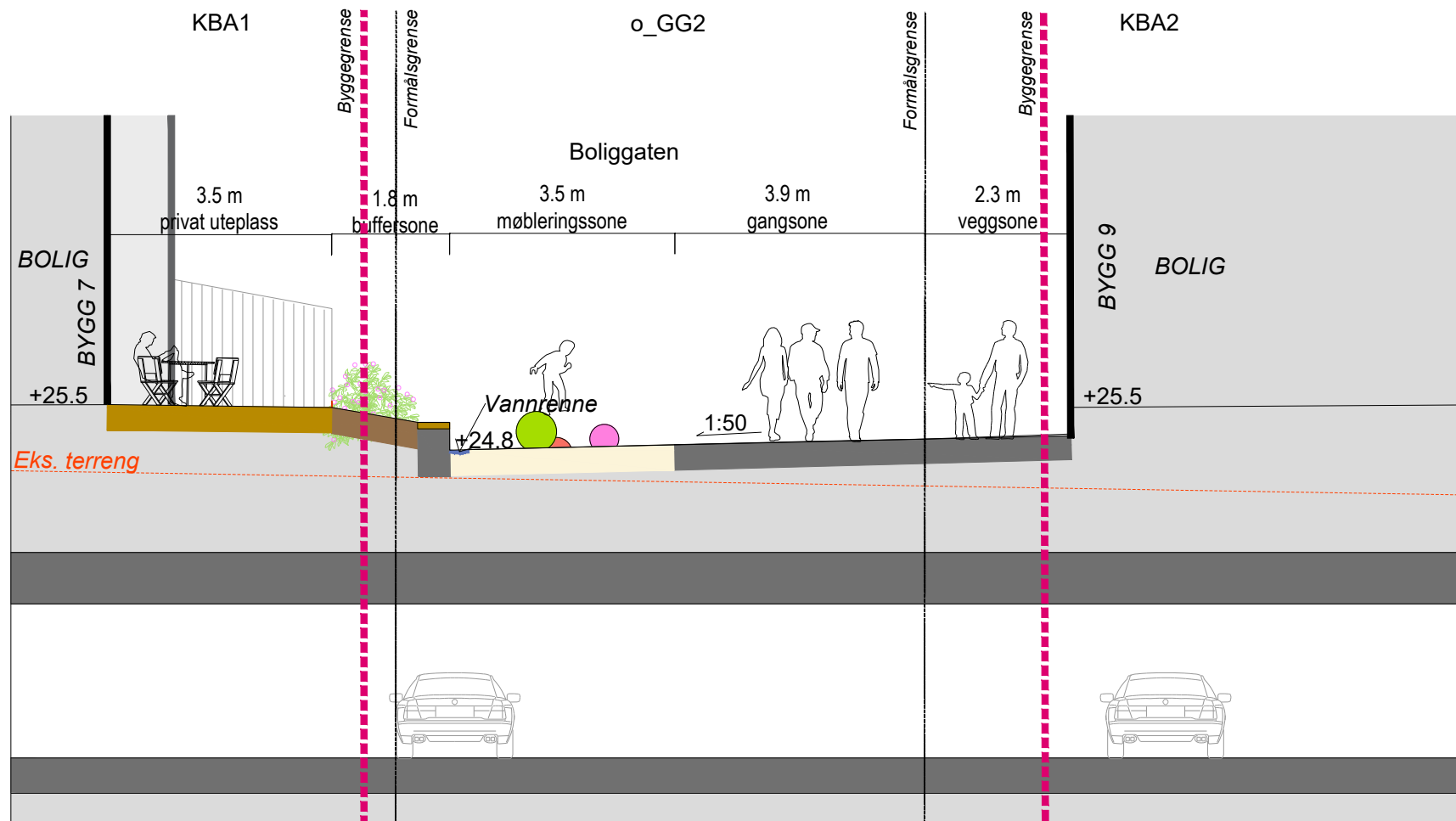

Prinsippsnitt M-M'

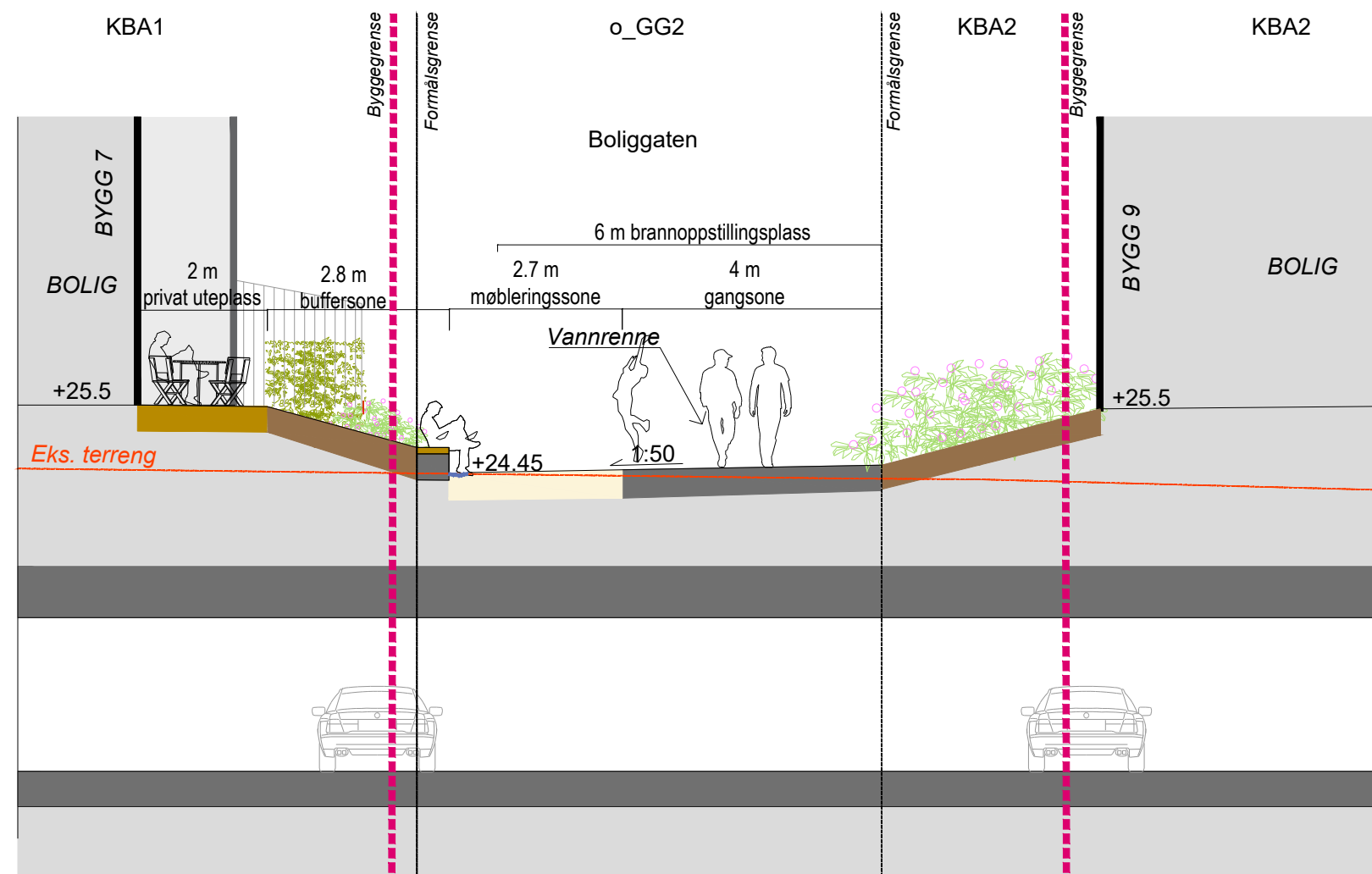

PROSJEKTFASE:		BASISKART		KOORDINATSYSTEM:		-	
REGULERINGSFASE		HØYDESISTEM:		NN2000		-	
OBOS Nye Hjem AS		EKVIDISTANSE:		-		-	
FABRIKKGATEN s19 OG S20 MINDEBYEN		Snitt L-L', M-M'					
SAK NR.:	TEGN NR.:	MÅLESTOKK:	TEGNET AV:	KONTR.:	DATO:	REV.:	
3002	L30-25	1:100(A3)	SH,JV	VJM	15.01.26		

Prinsippsnitt N-N' 1:150

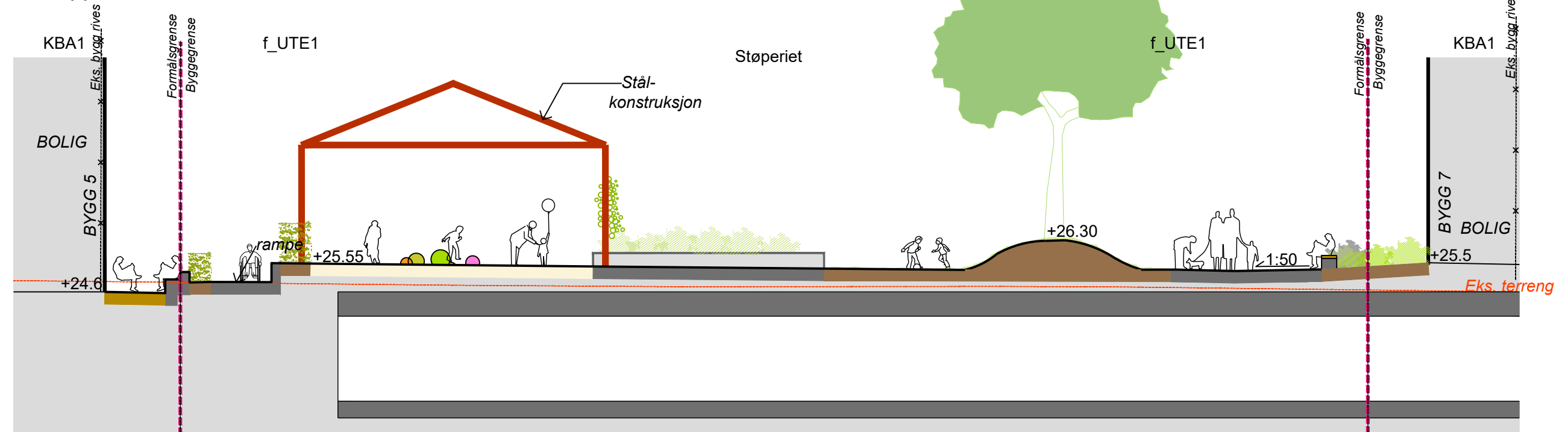

Snitt O-O' 1:100

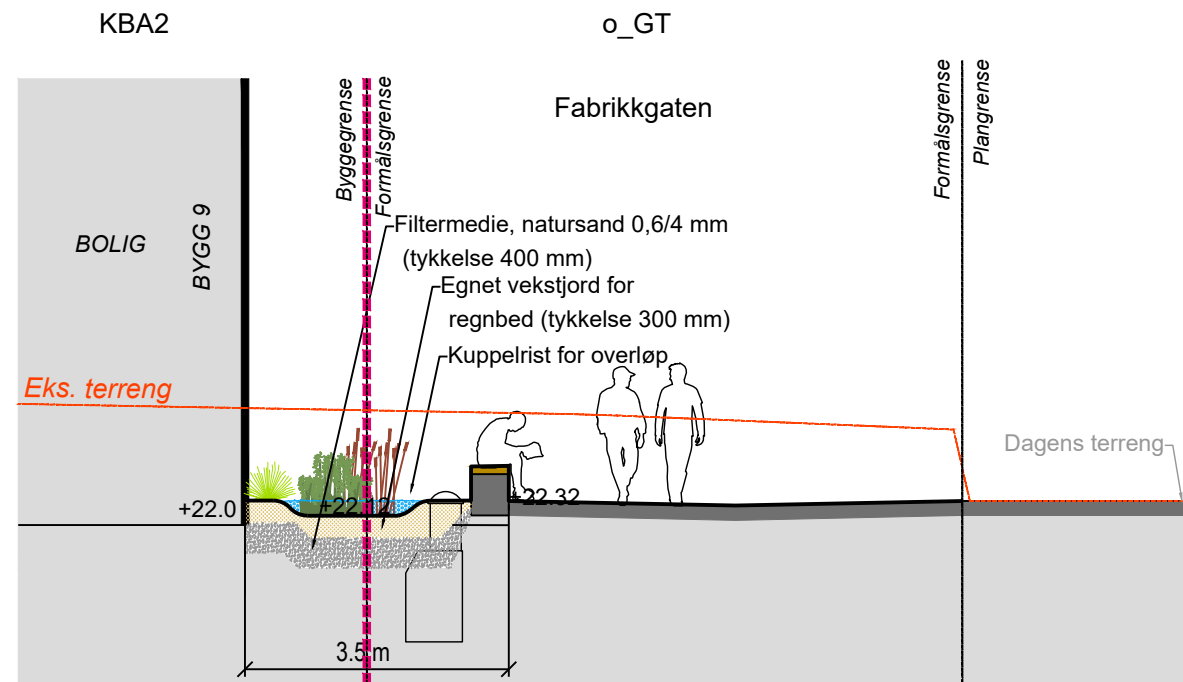

PROSJEKTFASE: REGULERINGSFASE		BASISKART KORDINATSYSTEM: - HØYDESISTEM: NN2000 EKVIDIANSE: -	
OBOS Nye Hjem AS FABRIKKGATEN s19 OG S20 MINDEBYEN Prinsippsnitt N-N', O-O'			
SAK NR.: 3002	TEGN.NR.: L30-26	MÅLESTOKK: VAR. (A3)	TEGNET AV: KONR: DATO: REV.: JV VJM 15.01.26

Prinsippsnitt P-P' - Mindehagen 1:200

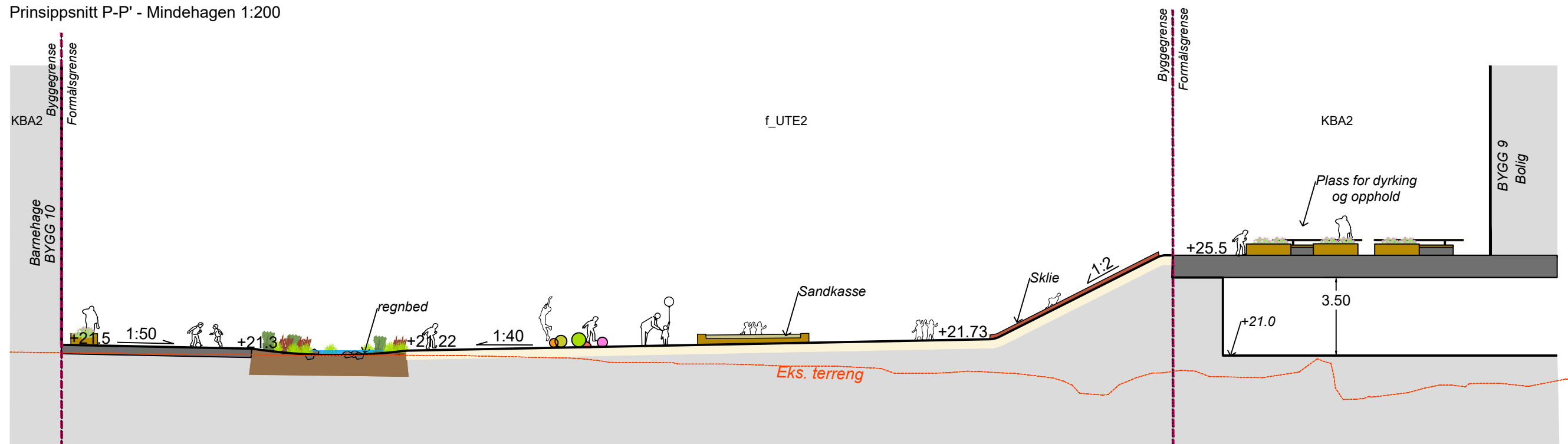

Prinsippsnitt Q-Q' 1:150

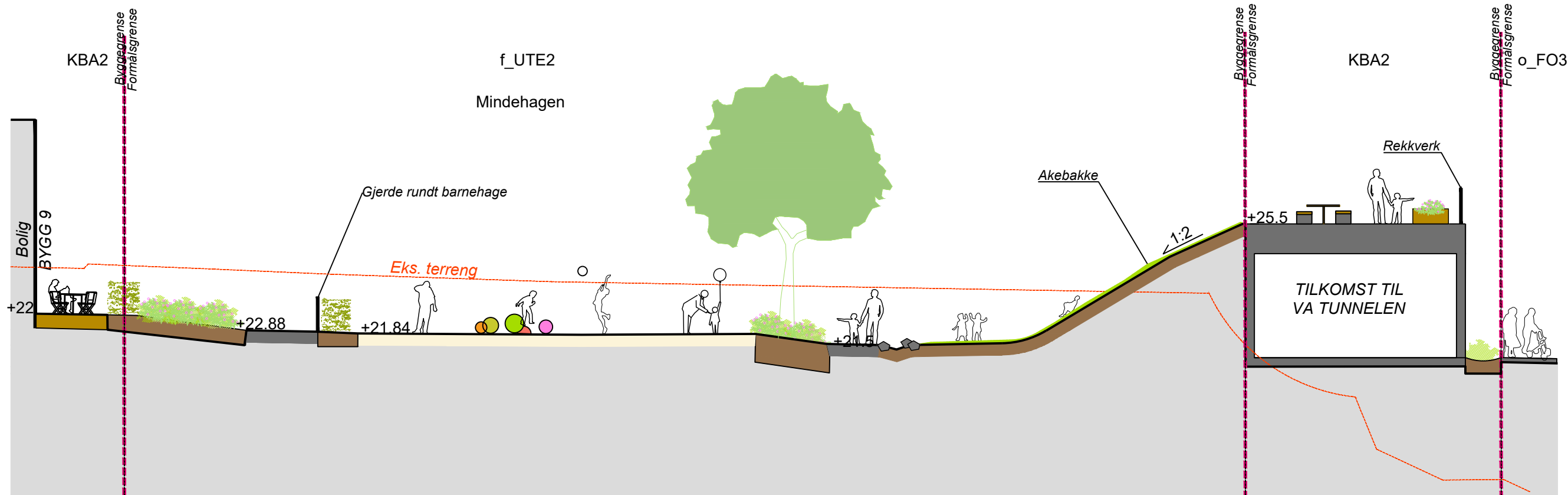

PROSJEKTFASE: REGULERINGSFASE		BASISKART KORDINATSYSTEM: - HØYDESISTEM: NN2000 EKVIDISTANSE: -	
OBOS Nye Hjem AS FABRIKKGATEN s19 OG S20 MINDEBYEN Prinsippsnitt P-P', Q-Q'			
SAK NR.: 3002	TEGN.NR.: L30-27	MÅLESTOKK: VAR. (A3)	TEGNET AV: KONR: DATO: REV.: JV VJM 15.01.26

SNITT OG OPPRISS

FABRIKKGATEN 3-5
Dato 28.01.2026

Terrengsnitt 1:1000

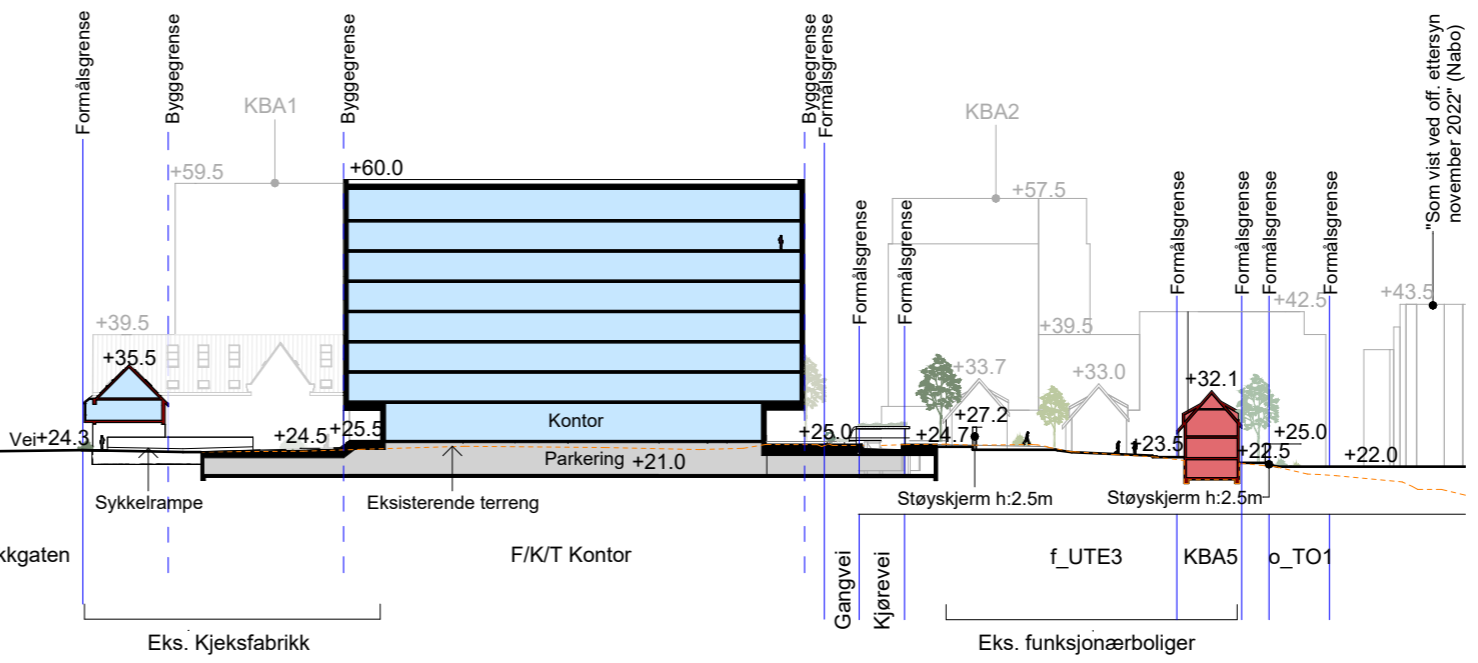
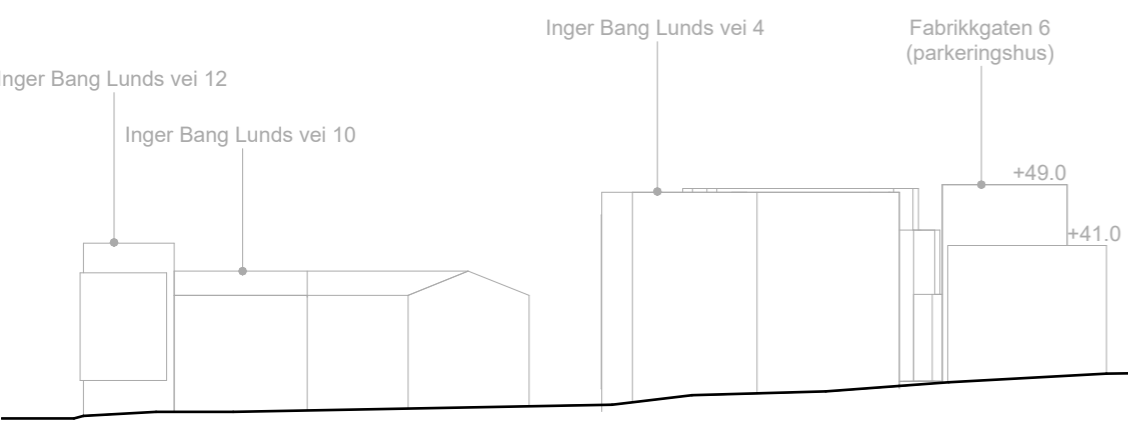
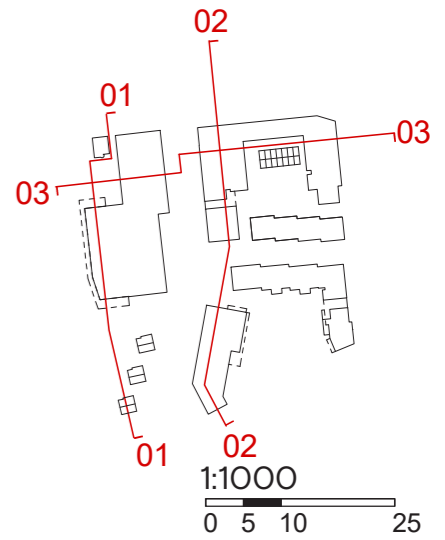

SNITT 01

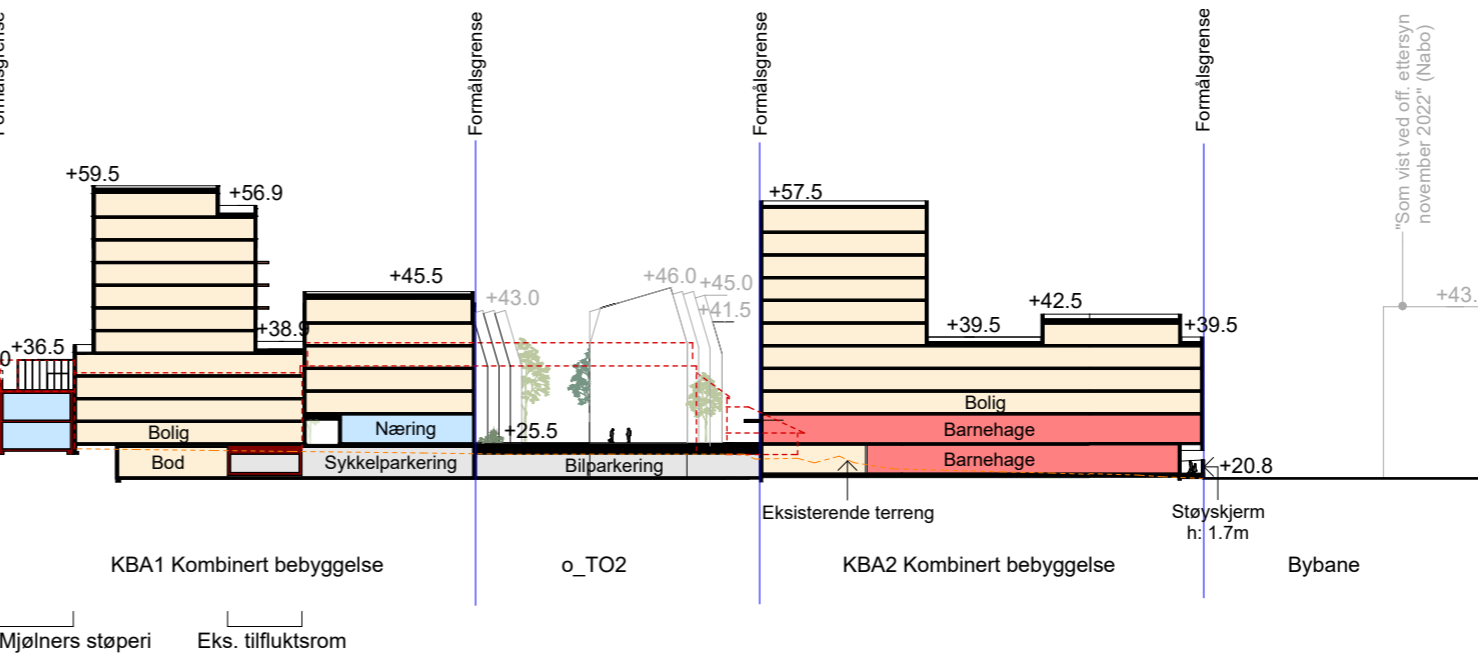
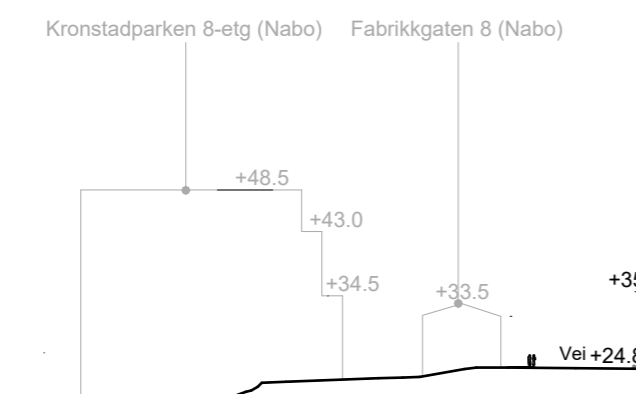

SNITT 02

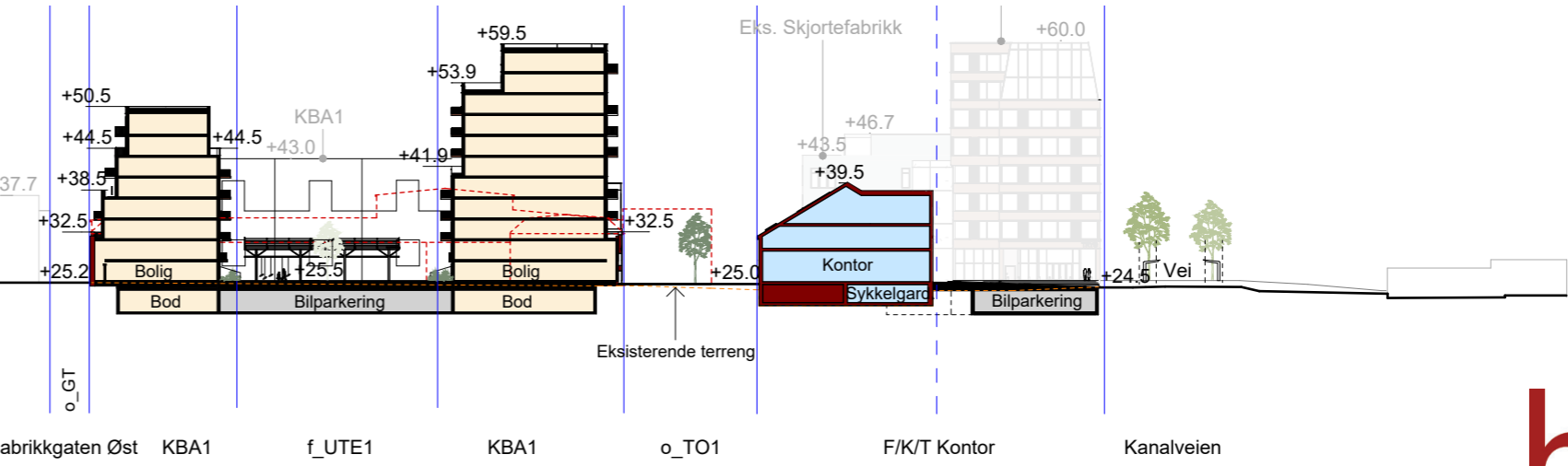
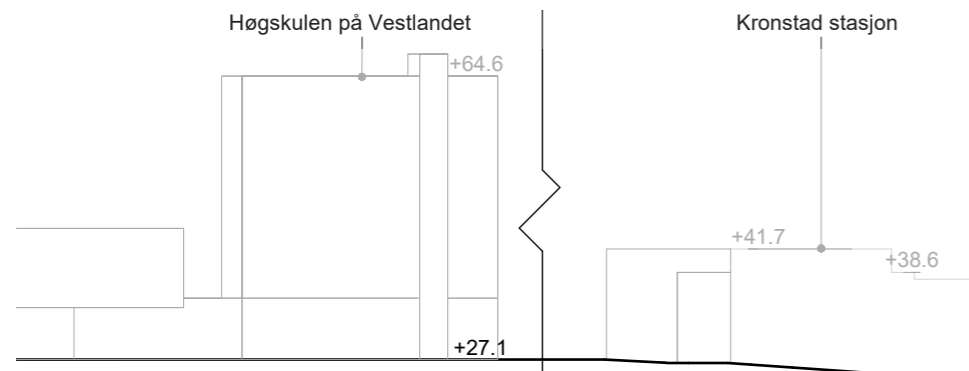

SNITT 03

Snitt 1:600

SNITT AA

LENGDESNITT S19: KJEKSFABRIKKEN - NYTT KONTORBYGG - FUNKSJONÆRHAGEN

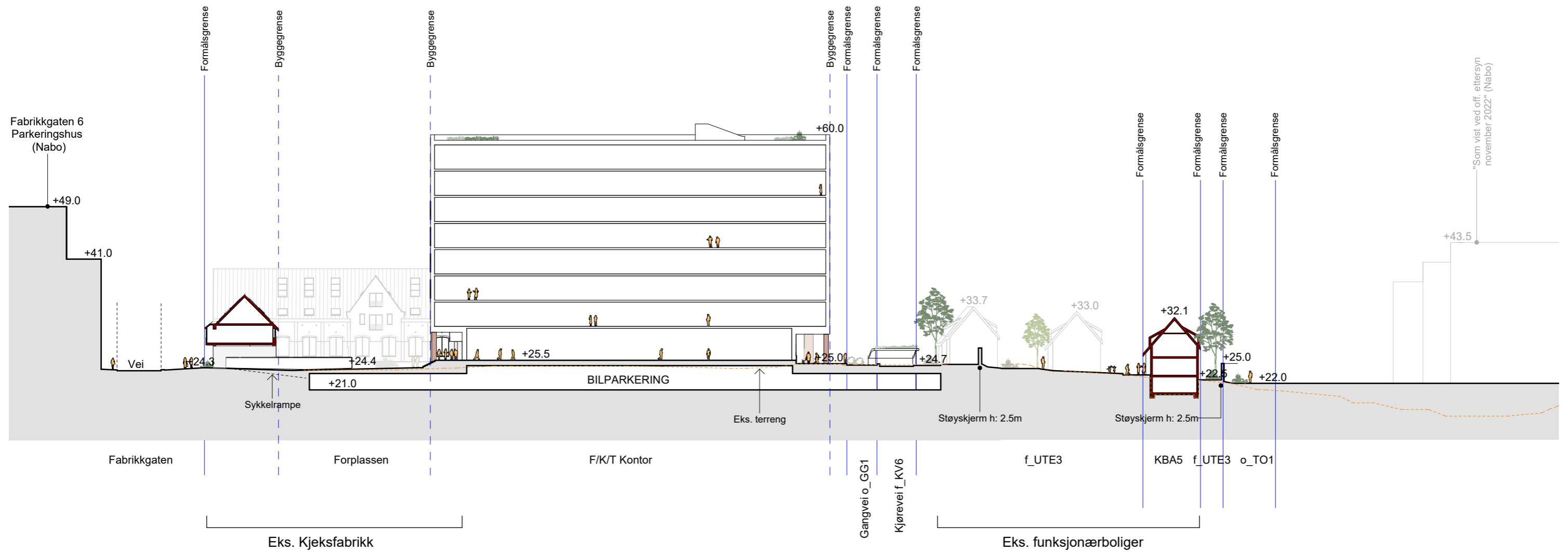
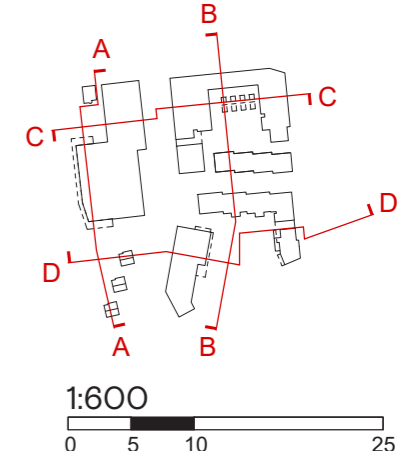

Snitt 1:600

SNITT BB

LENGDESNITT S20: MINDEHAGEN - BOLIGGATEN - STØPERIET

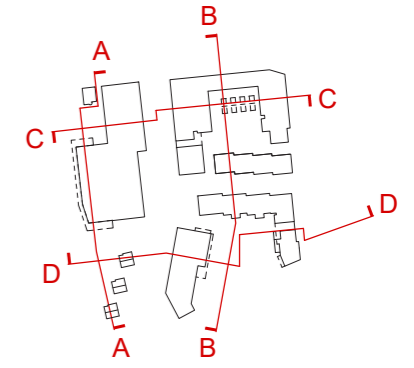

1:600

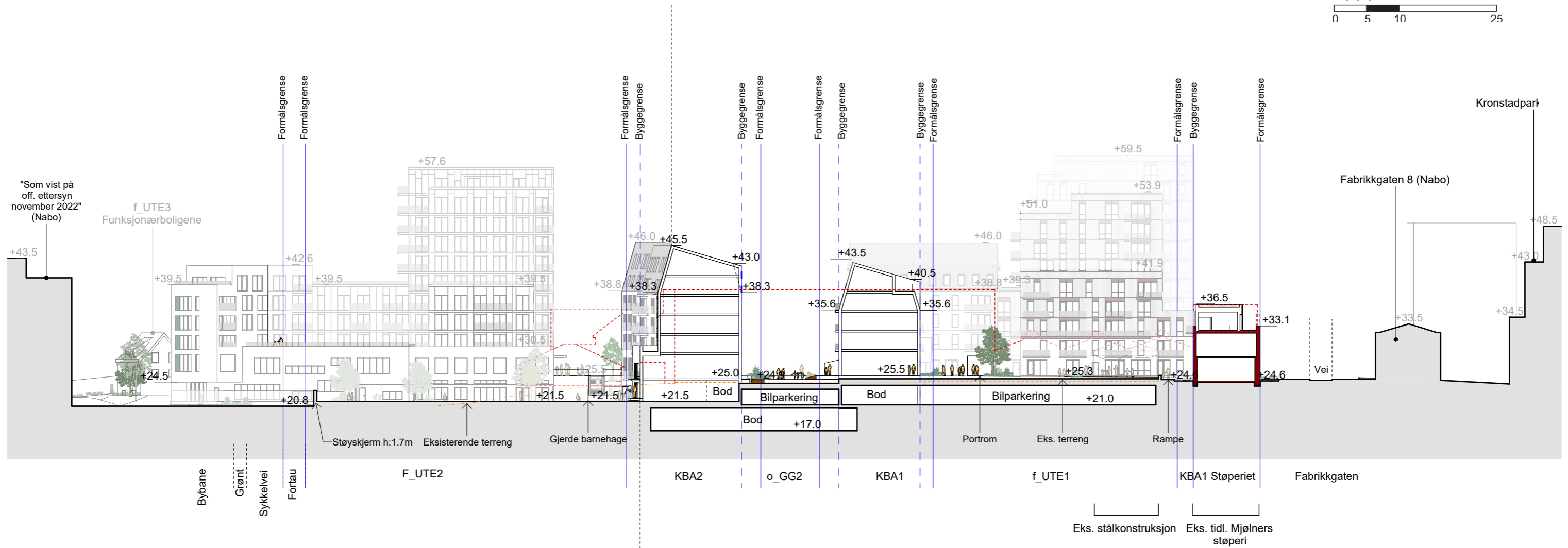

Snitt 1:600

SNITT CC

TVERRSNITT S20 OG S19: FABRIKKGATEN ØST - STØPERIET - FABRIKKALLMENNINGEN - KJEKSFABRIKKEN - FORPLASSEN

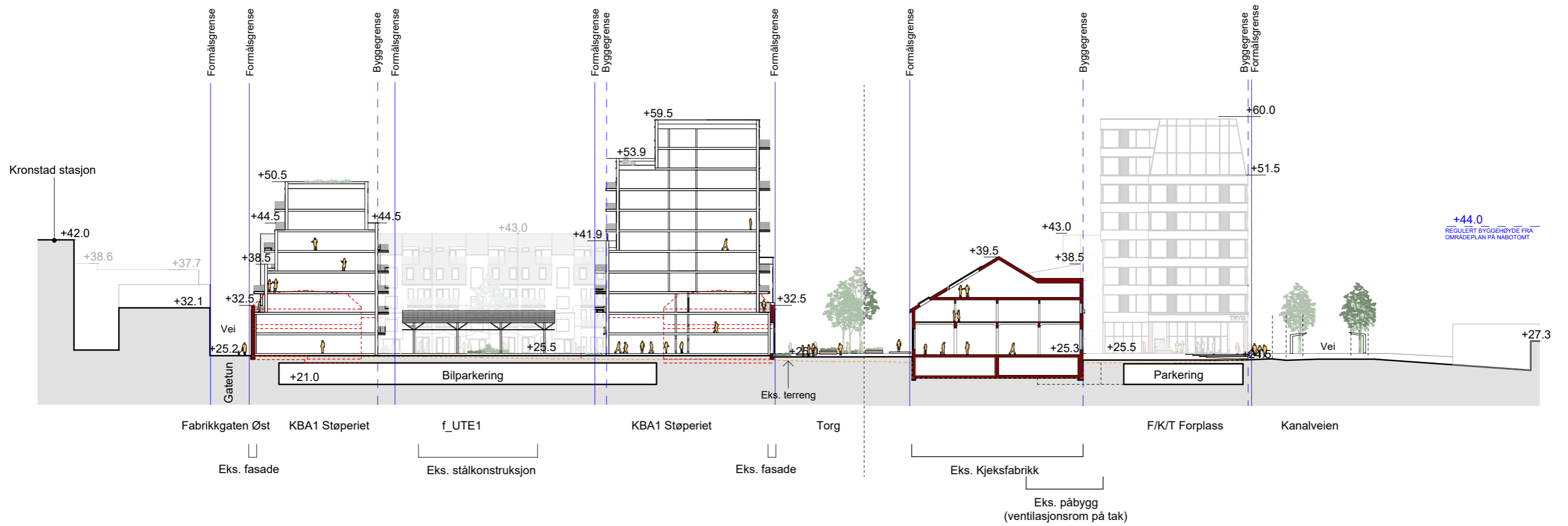
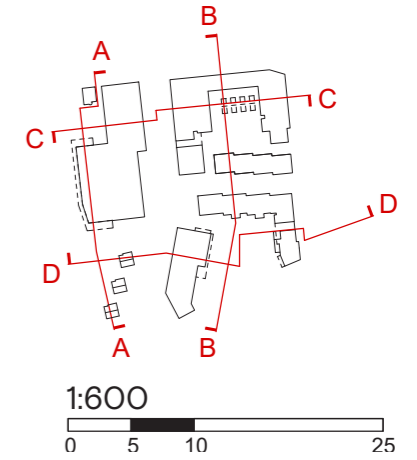

Snitt 1:600

SNITT DD

TVERRSNITT S20: NY BOLIGBEBYGGELSE MOT KROHNHAUGEN

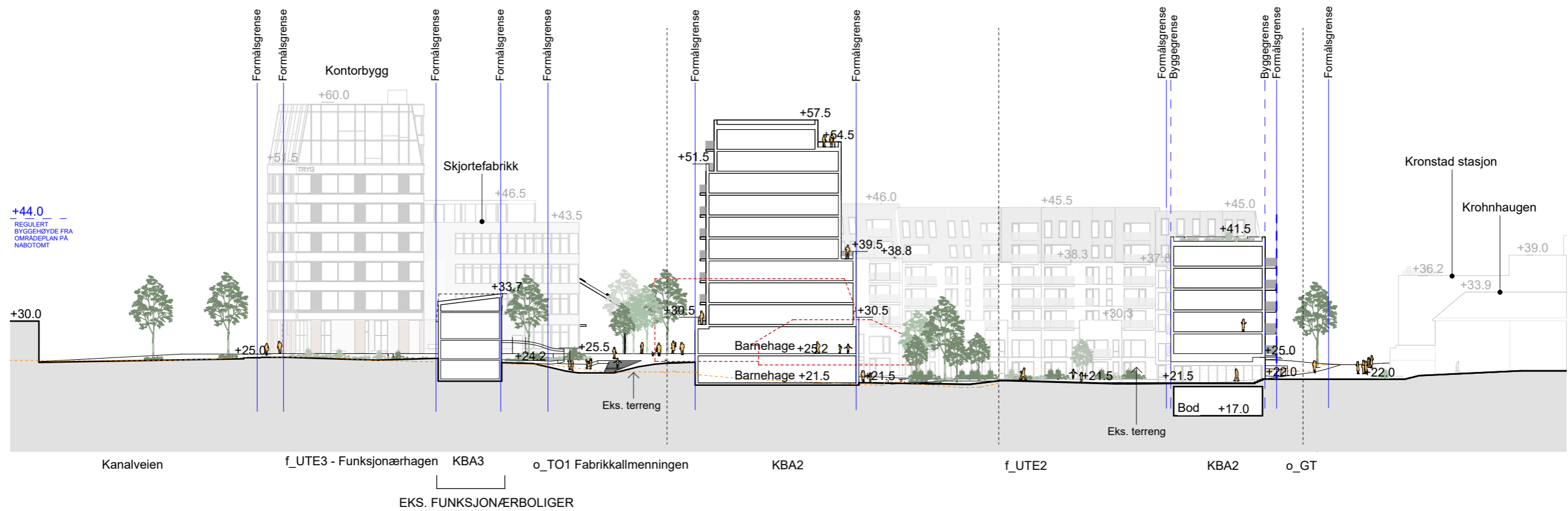
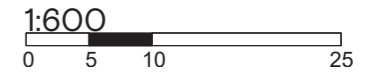
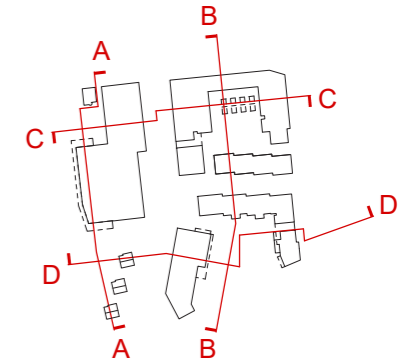

Oppriss

MÅLESTOKK 1:600

FASADE BB

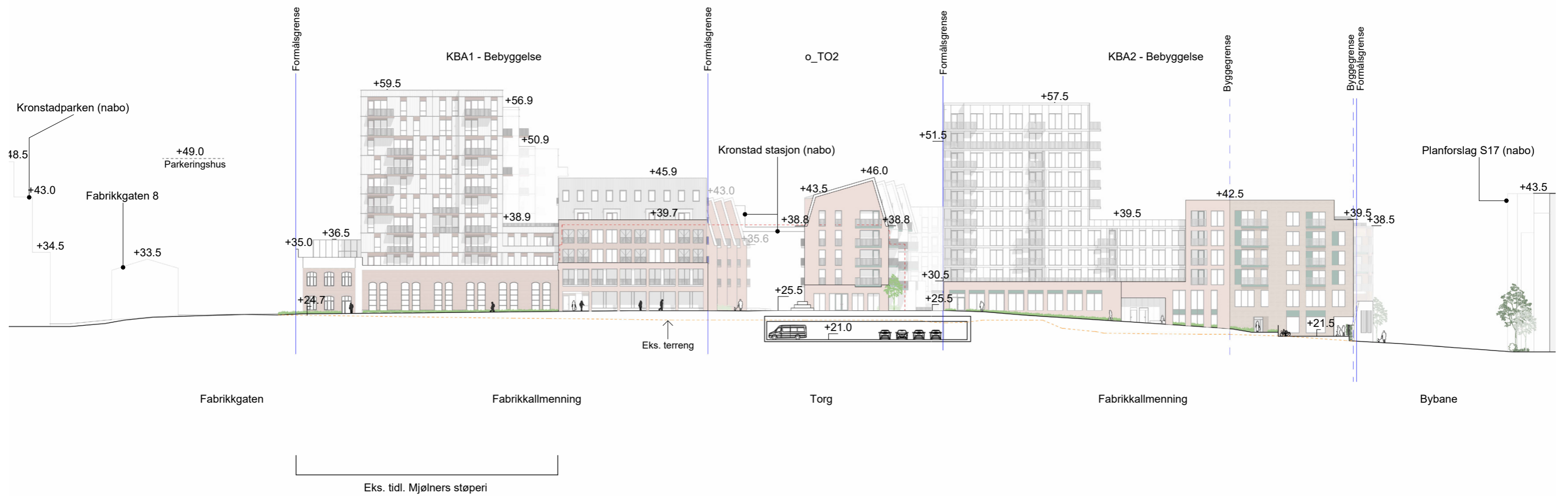
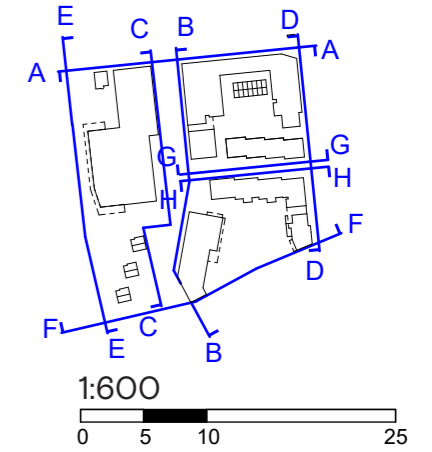

Oppriss

MÅLESTOKK 1:600

FASADE CC

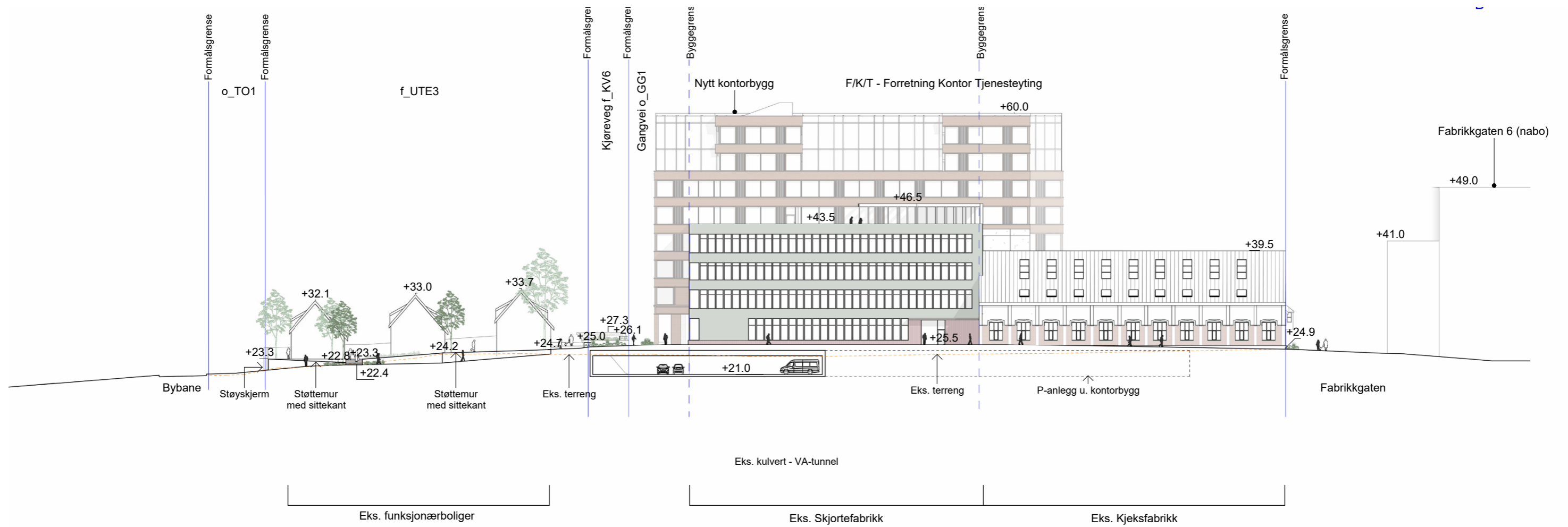
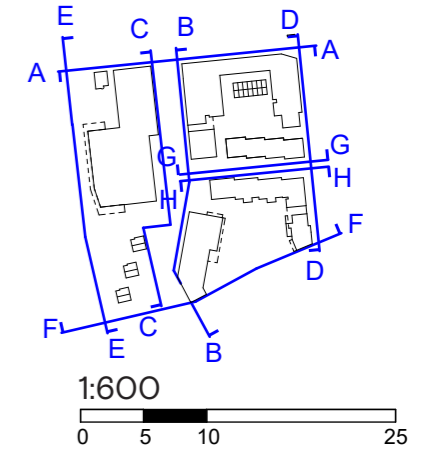

Oppriss

MÅLESTOKK 1:600

FASADE DD

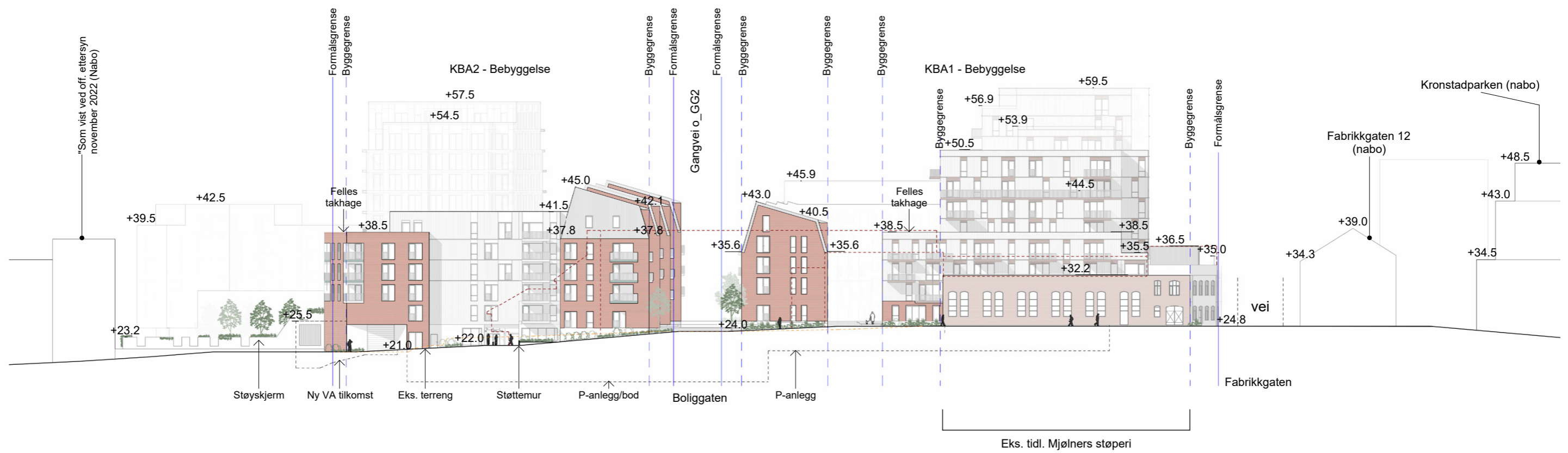
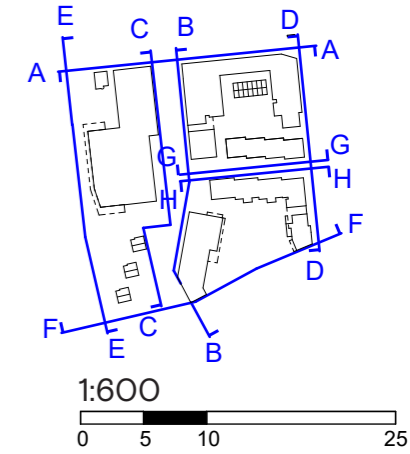

Oppriss

MÅLESTOKK 1:600

FASADE EE

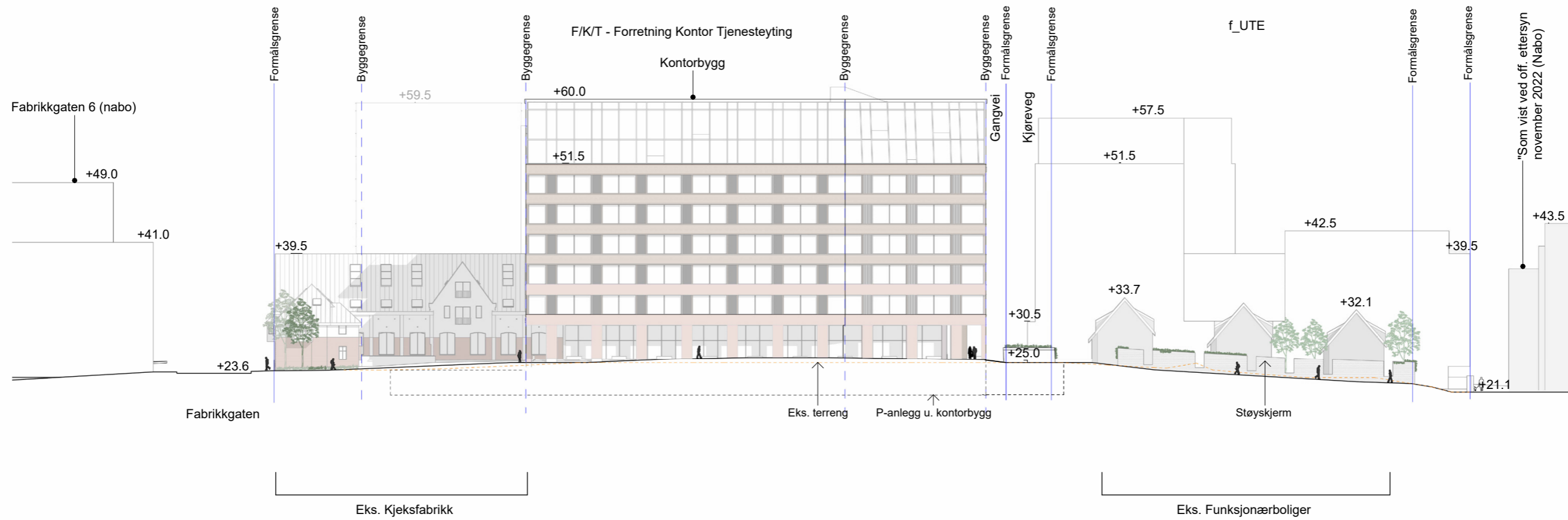
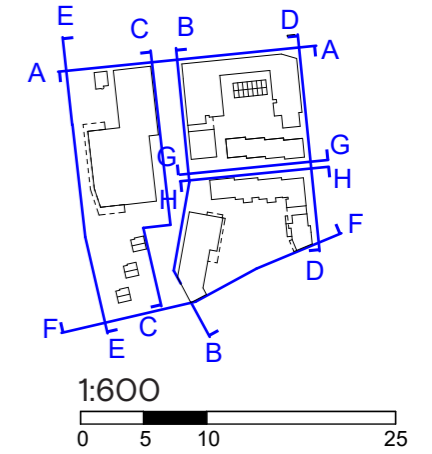

Oppriss

MÅLESTOKK 1:600

FASADE FF

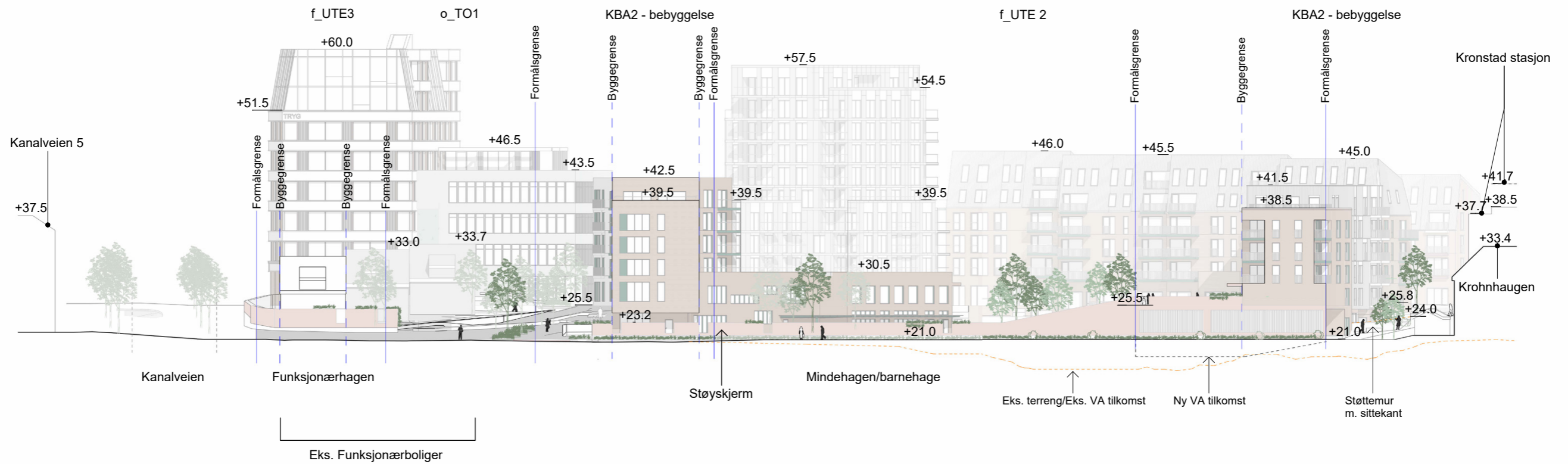
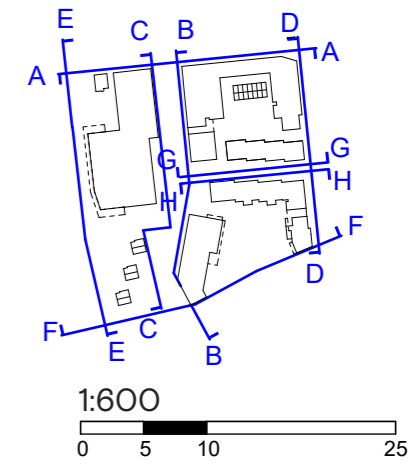

Oppriss

MÅLESTOKK 1:600

FASADE GG, FASADE HH

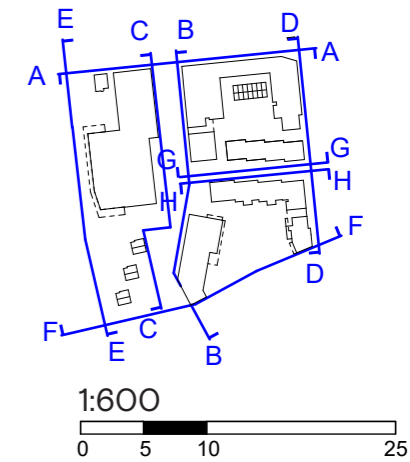

GG

1 : 600

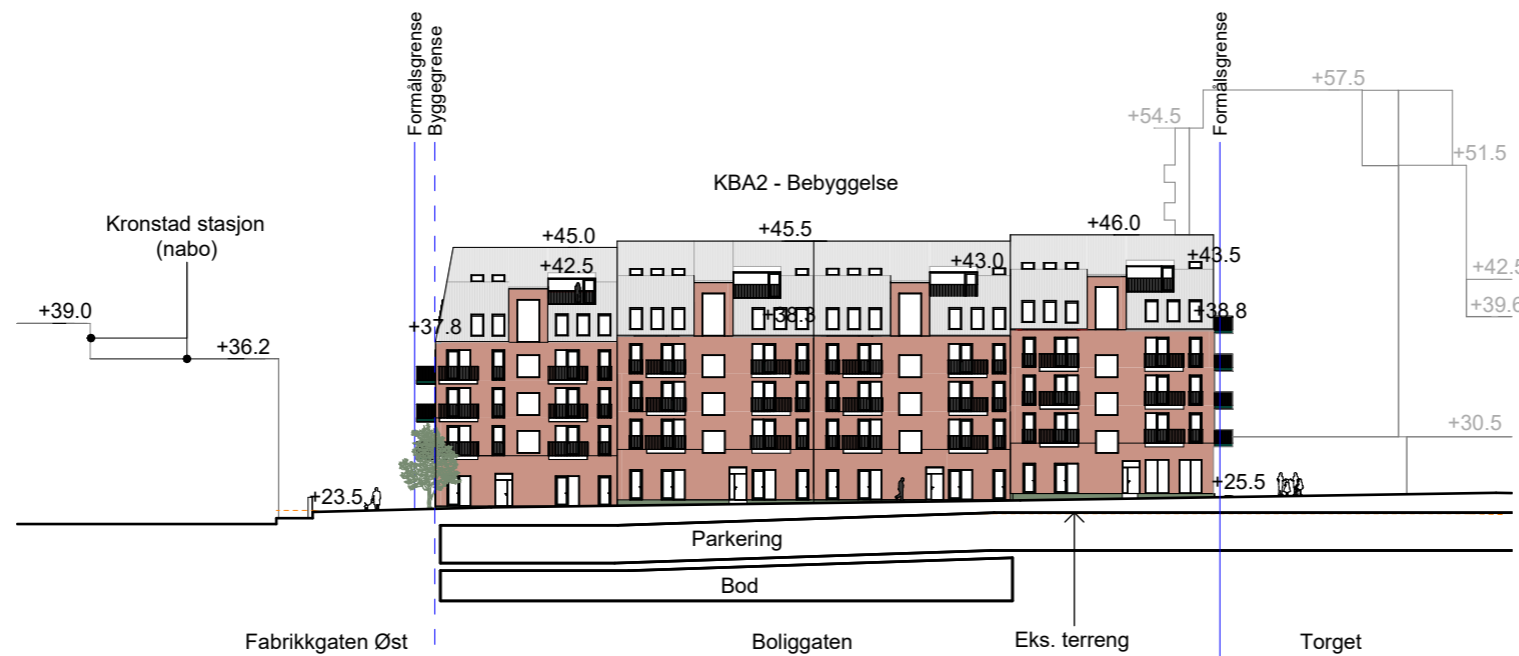

HH

1 : 600